

# **BERNARDO**®

www.bernardo.at

05 | 2025

## **MAGNETIC DRILLING MACHINES**



MD 3845 L  
MD 3850  
MD 5568  
MD 3850 PL  
MD 5568 PL  
MD 3550 eco  
MD 5050 V-eco  
MD 3550 VD  
MD 5050 VD  
MD 6050 VD  
MD 3550 PF

MD 8050 PF  
MD 3550 P  
MD 5050 P  
MD 3550 PA  
TPC 1000  
TPC 2000 S  
TPC 2200  
TPC 2000 Pro  
TPC 2400 Pro  
TPC 3500 Vario  
TPC 5000 Vario

***BERNARDO***<sup>®</sup>  
[www.bernardo.at](http://www.bernardo.at)

# Magnetic core drilling machine

## MD 3845 L

Compared to standard magnetic core drilling machines, the MD 3845 L features smaller dimension, making it the best option when working in limited spaces.

- Compact construction, ideal for working in limited spaces
- Spur gear designed for continuous operation
- Ratchet can be mounted on left or right machine side
- Ideal for steel construction, automobile industry and machine construction
- Compact construction allows for easy transport
- High magnetic force ensures high safety
- Ergonomically arranged control elements allow practical single hand operation
- Standard safety belt for vertical or over head operation



Clearly arranged control elements.



Powerful electro magnet guarantees best possible magnetic force



With practical handle

**BERNARDO**  
www.bernardo.at  
SEMIPROFESSIONAL

**NEW**



### Standard accessories:

- Plastic container
- Coolant tank
- Reversible ratchet
- Carry handle
- Safety belt
- User manual
- Tools

Compact design



### Technical data

### MD 3845 L

Core drill max. Ø	38 mm
Core drill max. drill depth	45 mm
Travel of drill head max.	50 mm
Idle speed	850 rpm
Arbor weldon shank	19 mm
Distance weldon shank / base max.	60 mm
Magnetic adhesion	14500 N
Dimension magnetic base (L x W x H)	156 x 80 x 50 mm
Motor power	1650 W
Voltage	230 V
Machine dimension (W x D x H)	150 x 280 x 250 mm
Weight approx.	10 kg
Art. no.	01-1368

# Magnetic core drilling machine

## MD 3850

Compared to standard magnetic core drilling machines, the MD 3850 features smaller dimension, making it the best option when working in limited spaces.

- Compact construction, ideal for working in limited spaces
- With bubble level as standard for perfect alignment
- Spur gear designed for continuous operation
- Ratchet can be mounted on left or right machine side
- Ideal for steel construction, automobile industry and machine construction
- Compact construction allows for easy transport
- High magnetic force ensures high safety
- Ergonomically arranged control elements allow practical single hand operation
- Standard safety belt for vertical or over head operation



Ideal for use in limited spaces



Delivered in high-quality transport box.



Logical arrangement of control elements on back of machine.



**BERNARDO**  
www.bernardo.at  
**PROFESSIONAL**

### Standard accessories:

- Safety belt
- Plastic container
- Bubble level
- Carry handle
- Reversible ratchet
- Lubricating pump
- User manual
- Tools

Technical data	MD 3850
Core drill max. Ø	38 mm
Core drill max. drill depth	50 mm
Travel of drill head max.	55 mm
Idle speed	850 U/min
Arbor weldon shank	19 mm
Distance weldon shank / base max.	65 mm
Magnetic adhesion	14500 N
Dimension magnetic base (L x W x H)	156 x 80 x 50 mm
Motor power	1650 W
Voltage	230 V
Machine dimension (W x D x H)	150 x 300 x 260 mm
Weight approx.	10 kg
Art. no.	01-1369

Great mobility



A ratchet that can be mounted on both sides makes working easier in confined spaces.

# Magnetic core drilling machine

## MD 5568

Compared to standard magnetic core drilling machines, the MD 5568 features smaller dimension, making it the best option when working in limited spaces.

- Standard safety belt for vertical or over head operation
- Ergonomically arranged control elements allow practical single hand operation
- High magnetic force ensures high safety
- Compact construction allows for easy transport
- Ideal for steel construction, automobile industry and machine construction
- Ratchet can be mounted on left or right machine side
- Spur gear designed for continuous operation
- With bubble level as standard for perfect alignment
- Compact construction, ideal for working in limited spaces

**BERNARDO**  
PROFESSIONAL

**NEW**



With bubble level for perfect alignment



Powerful magnet for secure hold and consistent results



**Best  
Price**

### Standard accessories:

- Safety belt
- Plastic container
- Bubble level
- Carry handle
- Reversible ratchet
- Lubricating pump
- User manual
- Tools

Technical data	MD 5568
Core drill max. Ø	55 mm
Core drill max. drill depth	68 mm
Travel of drill head max.	70 mm
Idle speed	750 rpm
Arbor weldon shank	19 mm
Distance weldon shank / base max.	75 mm
Magnetic adhesion	15500 N
Dimension magnetic base (L x W x H)	156 x 80 x 50 mm
Motor power	1900 W
Voltage	230 V
Machine dimension (W x D x H)	150 x 300 x 260 mm
Weight approx.	10 kg
Art. no.	01-13690



Wide range of accessories

Delivered in a robust plastic case with extensive accessories

# Magnetic core drilling machine

## MD 3850 PL

The MD 3850 PL core drilling machine offers a wide range of application possibilities. Its compact design, combined with powerful, flexible magnets, allows for use on a wide variety of surfaces, such as pipes of various sizes.

- Stepless, drill head height adjustment
- Ideal for steel construction, automobile industry and machine construction
- High magnetic holding force using flexible magnets for safe working
- Double-sided mounting lever, guarantees maximum user-friendliness
- Ergonomically arranged control elements allow practical single hand operation
- Standard safety belt for vertical or over head operation
- Tool holder designed for core drills with 19 mm weldon shaft
- High-quality component ensure long life span

**BERNARDO**  
www.bernardo.at  
SEMIPROFESSIONAL



**Best  
Price**



With bubble level for perfect alignment



Two flexible magnets guarantee a firm hold on various surfaces such as pipes of various sizes.

**Compact  
design**

**Incl. bubble level**

### Standard accessories:

- Metal box
- Coolant tank
- Bubble level
- Carry handle
- Reversible ratchet
- Lubricating pump
- Flexible magnets
- User manual
- Tools



### Technical data

### MD 3850 PL

Core drill max. Ø	38 mm
Core drill max. drill depth	50 mm
Travel of drill head max.	75 mm
Idle speed	850 rpm
Arbor weldon shank	19 mm
Distance weldon shank / base max.	95 mm
Magnetic adhesion	14500 N
Dimension magnetic base (L x W x H)	2 Stk. 185 x 40 x 50 mm
Motor power	1650 W
Voltage	230 V
Machine dimension (W x D x H)	170 x 330 x 290 mm
Weight approx.	11 kg
Art. no.	01-13691

# Magnetic core drilling machine

## MD 5568 PL

The MD 5568 PL core drilling machine offers a wide range of application possibilities. Its compact design, combined with powerful, flexible magnets, allows for use on a wide variety of surfaces, such as pipes of various sizes.

- High-quality component ensure long life span
- Tool holder designed for core drills with 19 mm weldon shaft
- Standard safety belt for vertical or over head operation
- Ergonomically arranged control elements allow practical single hand operation
- Double-sided mounting lever, guarantees maximum user-friendliness
- High magnetic holding force using flexible magnets for safe working
- Ideal for steel construction, automobile industry and machine construction
- Stepless, drill head height adjustment

**BERNARDO**  
www.bernardo.at  
**SEMIPROFESSIONAL**

**NEW**

Incl. bubble level



Intuitively operated switches for activating and deactivating the magnetic holding force



Ratchet can be mounted on both sides

Flexible magnets

### Standard accessories:

- Metal box
- Coolant tank
- Bubble level
- Carry handle
- Reversible ratchet
- Lubricating pump
- Flexible magnets
- User manual
- Tools

### Technical data

### MD 5568 PL

Core drill max. Ø	55 mm
Core drill max. drill depth	68 mm
Travel of drill head max.	75 mm
Idle speed	750 rpm
Arbor weldon shank	19 mm
Distance weldon shank / base max.	95 mm
Magnetic adhesion	15500 N
Dimension magnetic base (L x W x H)	2 Stk. 185 x 40 x 50 mm
Motor power	1900 W
Voltage	230 V
Machine dimension (W x D x H)	170 x 330 x 290 mm
Weight approx.	11 kg
Art. no.	01-13692



Perfect protection thanks to metal transport box

# Magnetic core drilling machine

## MD 3550 eco

The model MD 3550 eco is a versatile machine. Its low weight makes this model very mobile and great for vertical or over head operation.

- Stepless, drill head height adjustment, ideal when using long drill bits
- Ideal for steel construction, automobile industry and machine construction
- High magnetic force ensures high safety
- Ergonomically arranged control elements allow practical single hand operation
- Standard safety belt for vertical or over head operation
- Tool holder designed for core drills with 19 mm weldon shaft
- High-quality component ensure long life span
- Solid drill guide ensures optimal results

**BERNARDO**  
www.bernardo.at  
SEMIPROFESSIONAL



Precise and robust guide rails



Constant lubricant supply thanks to permanently mounted lubricant tank



Weldon shaft offers a wide range of tools

Automatic internal lubrication

Best  
Price

Drill head height can be extended, especially for long drills



### Standard accessories:

- Plastic container
- Coolant tank
- Arbor with automatic internal cooling
- Safety belt
- User manual
- Tools

Technical data	MD 3550 eco
Core drill max. Ø	35 mm
Core drill max. drill depth	50 mm
Twist drill max. Ø	13 mm
Travel of drill head max.	145 mm
Idle speed	830 rpm
Arbor weldon shank	19 mm
Distance weldon shank / base max.*	125 mm
Magnetic adhesion	16000 N
Dimension magnetic base (L x W x H)	165 x 80 x 50 mm
Motor power	1600 W
Voltage	230 V
Machine dimension (W x D x H)	260 x 320 x 500 mm
Weight approx.	11 kg
Art. no.	01-13695

\*Extendable by up to 110 mm



Perfect protection thanks to robust plastic case



# Magnetic core drilling machine MD 5050 V-eco

The model MD 5050 V-eco is a versatile machine. Its low weight makes this model very mobile and great for vertical or over head operation.

- Solid drill guide ensures optimal results
- High-quality component ensure long life span
- Tool holder designed for core drills with 19 mm weldon shaft
- Standard safety belt for vertical or over head operation
- High magnetic force ensures high safety
- Ideal for steel construction, automobile industry and machine construction
- Stepless, drill head height adjustment, ideal when using long drill bits



Clearly arranged control elements.

With Vario-drive  
Drill head height can be extended, especially for long drills



Powerful electro magnet guarantees best possible magnetic force



**Standard accessories:**

- Plastic container
- Coolant tank
- Arbor with automatic internal cooling
- Safety belt
- User manual
- Tools

Technical data	MD 5050 V-ECO
Core drill max. Ø	50 mm
Core drill max. drill depth	50 mm
Twist drill max. Ø	16 mm
Travel of drill head max.	170 mm
Idle speed	100 - 780 rpm
Arbor weldon shank	19 mm
Distance weldon shank / base max.*	145 mm
Magnetic adhesion	16500 N
Dimension magnetic base (L x W x H)	165 x 80 x 50 mm
Motor power	1650 W
Voltage	230 V
Machine dimension (W x D x H)	280 x 320 x 500 mm
Weight approx.	12 kg
Art. no.	01-13696

\*Extendable by up to 110 mm



Picture shows complete range of standard equipment

# Accessories for MD 3845 L / MD 3850 / MD 5568 / MD 3850 PL / MD 5568 PL / MD 3550 eco / MD 5050 V-eco

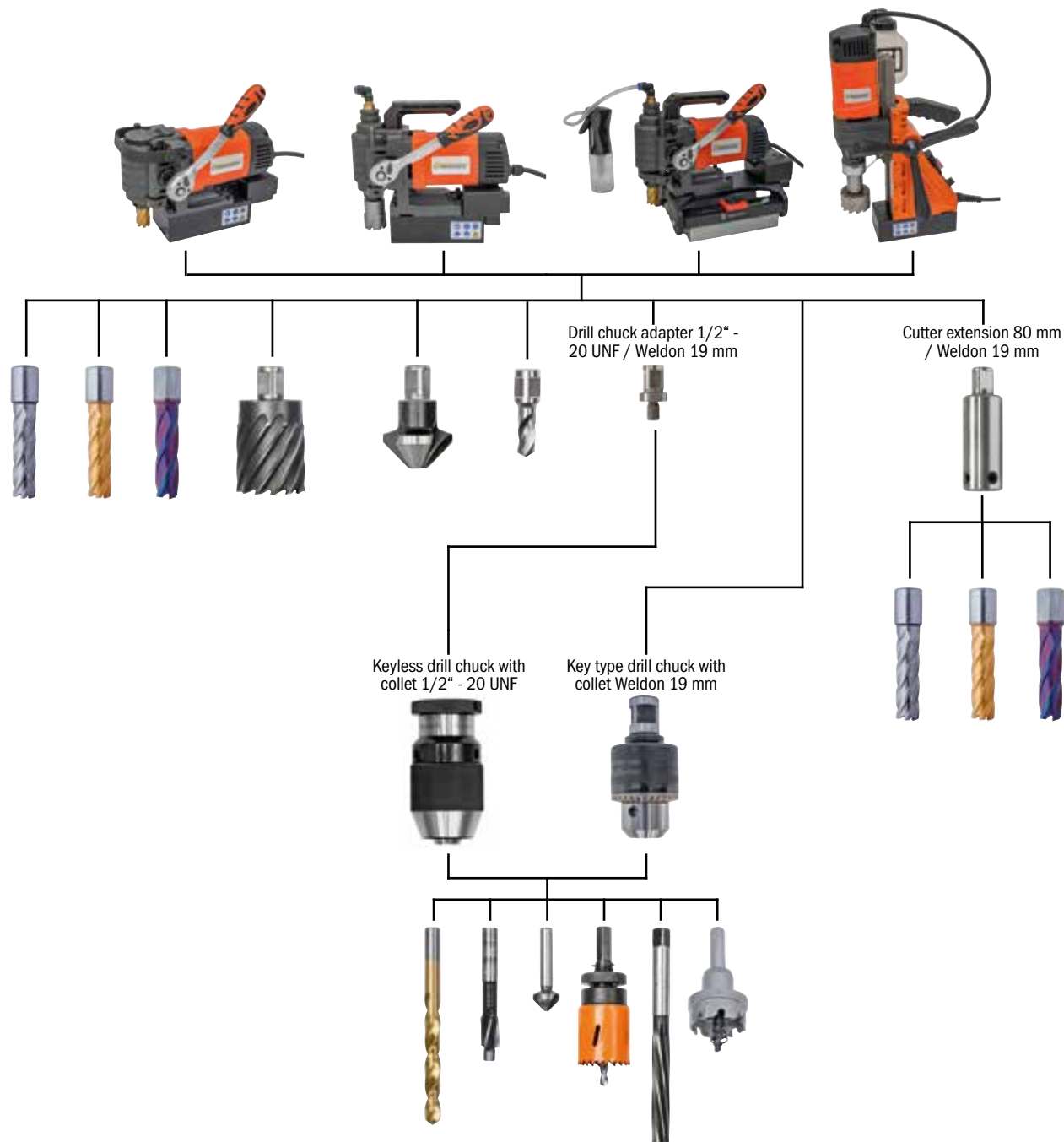

Art. no.	Description	excl. VAT	Art. no.	Description	excl. VAT
24-1075C	Key type drill chuck 1,5 - 13 mm / Weldon 19 mm		41-1105	HSS-core drills CDS, TiN-coated, 14/18/22 mm, 5 pcs.*	
24-1075D	Key type drill chuck 3 - 16 mm / Weldon 19 mm		41-11050	HSS-core drills CDL, TiN-coated, 14/18/22 mm, 5 pcs.**	
24-1076	Keyless drill chuck 1 - 13 mm / 1/2" - 20 UNF		41-11041	HSS-core drill-set CDS, TiN-coated, 14 - 24 mm*	
24-1076B	Keyless drill chuck 1 - 16 mm / 1/2" - 20 UNF		41-11042	HSS-core drill-set CDL, TiN-coated, 14 - 24 mm**	
53-1051	Drill chuck adapter 1/2" - 20 UNF / Weldon 19 mm		41-11043	HSSCO5-core drill-set CDS, nACO-coated, 14 - 24 mm***	
53-1054	Cutter extension 80 mm / Weldon 19 mm		41-11044	HSSCO5-core drill-set CDL, nACO-coated, 14 - 24 mm**	

\* Drilling depth 25 mm / \*\* Drilling depth 50 mm / \*\*\* Drilling depth 30 mm

**Example of use for MD 3845 L / MD 3850 / MD 5568 /  
MD 3850 PL / MD 5568 PL / MD 3550 eco / MD 5050 V-eco**



Carbide core drill



HSS-standard core drill



HSS-core drill TiN-coated



HSSCO5-core drill  
nACO-coated



Core drilling with cutter extension



Reaming



Twist drill with chuck



Hole saw with drill chuck



Countersink and deburring tools



Carbide hole saw



Countersink



Core drilling

# Magnetic core drilling machine with vario drive

## MD 3550 VD

- Variable speed setting allows optimal adjustment of speed when core drilling, countersinking, reaming,.....
- Powerful electro magnet guarantees best possible magnetic force
- Standard safety belt for vertical or over head operation
- High-quality component ensure long life span
- Automatic internal lubrication – coolant spreads direct on core drill
- Compared to twist drills, machine requires significantly less feed force when using core drills

**BERNARDO**  
www.bernardo.at  
**PROFESSIONAL**



Powerful magnetic base provides secure hold for consistent and precise results



Including bubble level for exact alignment

Vario-drive

### Standard accessories:

- Plastic container
- Coolant tank
- Bubble level
- Drill chuck adapter 1/2" - 20 UNF / Weldon 19 mm
- Key type drill chuck 1,5 - 13 mm
- Safety belt
- User manual
- Tools

Technical data	MD 3550 VD
Core drill max. Ø	35 mm
Core drill max. drill depth	50 mm
Twist drill max. Ø	13 mm
Travel of drill head max.	165 mm
Idle speed	100 - 870 rpm
Arbor weldon shank	19 mm
Distance weldon shank / base max.	175 mm
Magnetic adhesion	14800 N
Dimension magnetic base (L x W x H)	165 x 80 x 50 mm
Motor power	1550 W
Voltage	230 V
Machine dimension (W x D x H)	210 x 310 x 510 mm
Weight approx.	11 kg
Art. no.	01-1380



With bubble level



Delivered in a robust plastic case, including extensive accessories

# Magnetic core drilling machine with vario drive

## MD 5050 VD

- Compared to twist drills, machine requires significantly less feed force when using core drills
- Automatic internal lubrication – coolant spreads direct on core drill
- High-quality component ensure long life span
- Standard safety belt for vertical or over head operation
- Powerful electro magnet guarantees best possible magnetic force
- Variable speed setting allows optimal adjustment of speed when core drilling, countersinking, reaming,.....

**BERNARDO**  
www.bernardo.at  
**PROFESSIONAL**

Vario-drive



Automatic internal lubrication, coolant fluid goes straight to tip of core drill



Intuitively arranged control elements for easy handling, even under difficult conditions



Delivered in high-quality transport box.

### Standard accessories:

- Plastic container
- Coolant tank
- Drill chuck adapter 1/2" - 20 UNF / Weldon 19 mm
- Key type drill chuck 1,5 - 13 mm
- Safety belt
- User manual
- Tools

Technical data	MD 5050 VD
Core drill max. Ø	50 mm
Core drill max. drill depth	50 mm
Twist drill max. Ø	13 mm
Travel of drill head max.	165 mm
Idle speed	100 - 830 rpm
Arbor weldon shank	19 mm
Distance weldon shank / base max.	175 mm
Magnetic adhesion	15600 N
Dimension magnetic base (L x W x H)	165 x 80 x 50 mm
Motor power	1700 W
Voltage	230 V
Machine dimension (W x D x H)	210 x 310 x 560 mm
Weight approx.	11,5 kg
Art. no.	01-1383



Delivered in a robust plastic case

# Magnetic core drilling machine with vario drive

## MD 6050 VD

- Variable speed setting allows optimal adjustment of speed when core drilling, tapping, countersinking or reaming
- With bubble level as standard for perfect alignment
- Complete with MT 2 taper for mounting of several tools (twist drills, countersinking bits, reamers, tapping chucks, keyhole saws etc.)
- Automatic internal lubrication – coolant spreads direct on core drill
- Powerful electro magnet guarantees best possible magnetic force
- Ideal for steel construction, automobile industry and machine construction



Exact adjustment of the cutting speed using a potentiometer.



Precise alignment of the machine using the standard bubble level.



Powerful electromagnet for high magnetic holding force

### Standard accessories:

- Plastic container
- Coolant tank
- Bubble level
- Arbor with automatic internal cooling MT 2 / Weldon 19 mm
- Safety belt
- User manual
- Tools

Great mobility

Spindle taper  
MT 2



**BERNARDO**  
PROFESSIONAL

Vario-drive

Best  
Price

Technical data	MD 6050 VD
Core drill max. Ø	60 mm
Core drill max. drill depth	50 mm
Twist drill max. Ø	23 mm
Travel of drill head max.	180 mm
Idle speed, stepless	100 - 470 rpm
Spindle taper	MK 2
Arbor weldon shank	19 mm
Distance spindle / base max.	220 mm
Distance weldon shank / base max.	125 mm
Magnetic adhesion	16000 N
Dimension magnetic base (L x W x H)	200 x 105 x 45 mm
Motor power	1890 W
Voltage	230 V
Machine dimension (W x D x H)	220 x 360 x 630 mm
Weight approx.	17 kg
Art. no.	01-1384



Complete standard accessories

# Accessories for MD 3550 VD / MD 5050 VD

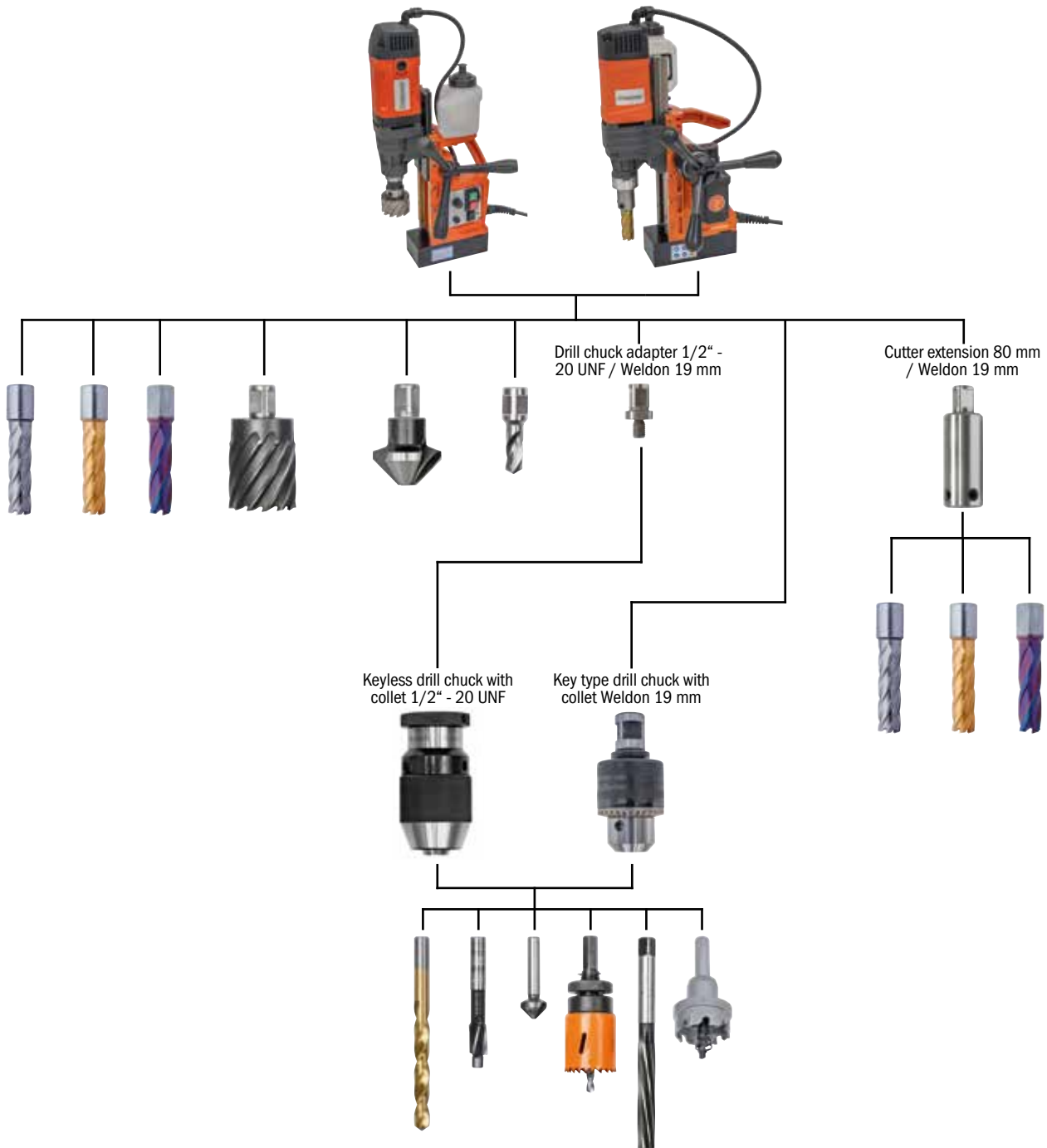

Art. no.	Description	excl. VAT	Art. no.	Description	excl. VAT
24-1075C	Key type drill chuck 1,5 - 13 mm / Weldon 19 mm		41-1105	HSS-core drills CDS, TiN-coated, 14/18/22 mm, 5 pcs.*	
24-1075D	Key type drill chuck 3 - 16 mm / Weldon 19 mm		41-11050	HSS-core drills CDL, TiN-coated, 14/18/22 mm, 5 pcs.**	
24-1076	Keyless drill chuck 1 - 13 mm / 1/2" - 20 UNF		41-11041	HSS-core drill-set CDS, TiN-coated, 14 - 24 mm*	
24-1076B	Keyless drill chuck 1 - 16 mm / 1/2" - 20 UNF		41-11042	HSS-core drill-set CDL, TiN-coated, 14 - 24 mm**	
53-1051	Drill chuck adapter 1/2" - 20 UNF / Weldon 19 mm		41-11043	HSSCO5-core drill-set CDS, nACO-coated, 14 - 24 mm***	
53-1054	Cutter extension 80 mm / Weldon 19 mm		41-11044	HSSCO5-core drill-set CDL, nACO-coated, 14 - 24 mm**	

\* Drilling depth 25 mm / \*\* Drilling depth 50 mm / \*\*\* Drilling depth 30 mm

# Magnetic core drilling machine with automatic feed

## MD 3550 PF

- Stepless, drill head height adjustment, ideal when using long drill bits
- Ideal for steel construction, automobile industry and machine construction
- High magnetic force ensures high safety
- Ergonomically arranged control elements allow practical single hand operation
- Standard safety belt for vertical or over head operation
- Tool holder designed for core drills with 19 mm weldon shaft
- High-quality component ensure long life span
- Solid drill guide ensures optimal results
- With automatic feed



Automatic internal lubrication, coolant fluid goes straight to tip of core drill



Robust guideway for increased stability.



With lever mechanism for automatic feed



Powerful electro magnet guarantees best possible magnetic force

### Standard accessories:

- Metal box
- Coolant tank
- Arbor with automatic internal cooling
- Safety belt
- User manual
- Tools

Technical data	MD 3550 PF
Core drill max. Ø	35 mm
Core drill max. drill depth	50 mm
Twist drill max. Ø	13 mm
Travel of drill head max.	150 mm
Idle speed	830 rpm
Arbor weldon shank	19 mm
Distance weldon shank / base max.*	125 mm
Magnetic adhesion	16000 N
Dimension magnetic base (L x W x H)	165 x 80 x 50 mm
Motor power	1600 W
Voltage	230 V
Machine dimension (W x D x H)	260 x 310 x 490 mm
Weight approx.	13,5 kg
Art. no.	01-13850

\*Extendable by up to 110 mm

**BERNARDO**  
PROFESSIONAL

Drill head height can be extended, especially for long drills

Automatic internal lubrication

**NEW**

With automatic feed



Complete standard accessories



# Magnetic core drilling machine with automatic feed

## MD 8050 PF

- Three speed levels for optimal adjustment of the cutting speed when core drilling, countersinking, reaming, etc.
- With fully automatic feed and automatic adjustment of the feed speed
- Standard safety belt for vertical or over head operation
- High-quality component ensure long life span
- Automatic internal lubrication – coolant spreads direct on core drill
- Compared to twist drills, machine requires significantly less feed force when using core drills
- Tool holder designed for core drills with 19 mm weldon shaft



Clearly arranged control elements.



Easy selection of the appropriate cutting speed



Delivered in a high-quality metal transport box with extensive accessories.

### Standard accessories:

- Metal box
- Coolant tank
- Bubble level
- Arbor with automatic internal cooling MT 2 / Weldon 19 mm
- Safety belt
- User manual
- Tools

Drill head height can be extended, especially for long drills

Spindle taper MT 2

Technical data	MD 8050 PF
Core drill max. Ø	80 mm
Core drill max. drill depth	50 mm
Twist drill max. Ø	23 mm
Travel of drill head max.	147 mm
Idle speed	165 / 350 / 750 rpm
Spindle taper	MT 2
Arbor weldon shank	19 mm
Distance weldon shank / base max.*	135 mm
Magnetic adhesion	17600 N
Dimension magnetic base (L x W x H)	185 x 90 x 50 mm
Motor power	2690 W
Voltage	230 V
Machine dimension (W x D x H)	240 x 320 x 530 mm
Weight approx.	18 kg
Art. no.	01-13852

\*Extendable by up to 110 mm



3 speed steps

Automatic feed

**BERNARDO**  
PROFESSIONAL

# Magnetic core drilling machine with permanent magnet

## MD 3550 P

- Ideal for steel construction, automobile industry and machine construction
- Ergonomic design with practical handle
- Two flexible, powerful magnets provide a secure hold, especially on materials such as shaped pipes
- Automatic internal lubrication – coolant spreads direct on core drill
- Variable speed setting allows optimal adjustment of speed when core drilling, tapping, countersinking or reaming

**BERNARDO®**  
www.bernardo.at  
**PROFESSIONAL**

Drill head height can be extended, especially for long drills



Robust and high-quality workmanship guarantees precise results



Flexible magnets for perfect hold, for example on pipes



Including lubricant tank



### Standard accessories:

- Metal box
- Coolant tank
- Arbor with automatic internal cooling
- Safety belt
- User manual
- Tools

Vario-drive

Technical data	MD 3550 P
Core drill max. Ø	35 mm
Core drill max. drill depth	50 mm
Twist drill max. Ø	16 mm
Travel of drill head max.	150 mm
Idle speed, stepless	100 - 830 rpm
Arbor weldon shank	19 mm
Distance weldon shank / base max.*	160 mm
Magnetic adhesion	16000 N
Dimension magnetic base (L x W x H)	85 x 40 x 50 mm (2 pcs.)
Motor power	1600 W
Voltage	230 V
Machine dimension (W x D x H)	250 x 290 x 520 mm
Weight approx.	12,5 kg
Art. no.	01-13853

\*Extendable by up to 110 mm



Perfect protection against shocks and damage thanks to the metal box

# Magnetic core drilling machine with permanent magnet

## MD 5050 P

- Variable speed setting allows optimal adjustment of speed when core drilling, tapping, countersinking or reaming
- Automatic internal lubrication – coolant spreads direct on core drill
- Two flexible, powerful magnets provide a secure hold, especially on materials such as shaped pipes
- Ergonomic design with practical handle
- Ideal for steel construction, automobile industry and machine construction



Drill head height can be extended, especially for long drills



Automatic internal lubrication, coolant fluid goes straight to tip of core drill



Robust guidance ensures maximum stability.



Variable adjustment of the spindle speed, using a potentiometer



Perfect hold thanks to flexible, powerful magnets



### Standard accessories:

- Metal box
- Coolant tank
- Arbor with automatic internal cooling
- Safety belt
- User manual
- Tools

Vario-drive

Best Price

Technical data	MD 5050 P
Core drill max. Ø	50 mm
Core drill max. drill depth	50 mm
Twist drill max. Ø	16 mm
Travel of drill head max.	160 mm
Idle speed, stepless	100 - 780 rpm
Arbor weldon shank	19 mm
Distance weldon shank / base max.*	165 mm
Magnetic adhesion	16500 N
Dimension magnetic base (L x W x H)	85 x 40 x 50 mm (2 pcs.)
Motor power	1700 W
Voltage	230 V
Machine dimension (W x D x H)	250 x 290 x 530 mm
Weight approx.	12,5 kg
Art. no.	01-13854

\*Extendable by up to 110 mm



Delivered in a practical and robust metal box

# Magnetic core drilling machine with permanent magnet

## MD 3550 PA

- Battery-powered core drilling machine, ideal for use in locations without direct power supply
- Automatic internal lubrication – coolant spreads direct on core drill
- Durable, brushless motor, with high quality and wear resistance
- Comes standard with Weldon shank for various tools (twist drills, countersinks, reamers, etc.)
- Ergonomic design for maximum flexibility and productivity
- Two flexible, powerful magnets provide a secure hold, especially on materials such as shaped pipes



Includes two powerful batteries and charger



Perfect hold thanks to flexible, powerful magnets



Stable guidance for precise results



Automatic internal lubrication, coolant fluid goes straight to tip of core drill

Incl. charger

Includes powerful 36 V batteries (2 pcs.)

Great mobility

Best Price

NEW



**BERNARDO**  
www.bernardo.at  
**PROFESSIONAL**

Right-left turning

### Standard accessories:

- Safety belt
- Metal box
- Coolant tank
- Arbor with automatic internal cooling
- 2 powerful batteries (36 V) incl. charger
- User manual
- Tools

Technical data	MD 3550 PA
Core drill max. Ø	35 mm
Core drill max. drill depth	50 mm
Twist drill max. Ø	16 mm
Travel of drill head max.	160 mm
Idle speed	100 - 960 rpm
Arbor weldon shank	19 mm
Distance weldon shank / base max.	180 mm
Dimension magnetic base (L x W x H)	85 x 40 x 50 mm (2 pcs.)
Battery capacity	5000 mAh
Battery voltage	40 V
Machine dimension (W x D x H)	240 x 270 x 550 mm
Weight approx.	11 kg
Art. no.	01-13855



Extensive accessories in a robust metal box

# Accessories for MD 3550 PF / MD 3550 P / MD 5050 P / MD 3550 PA

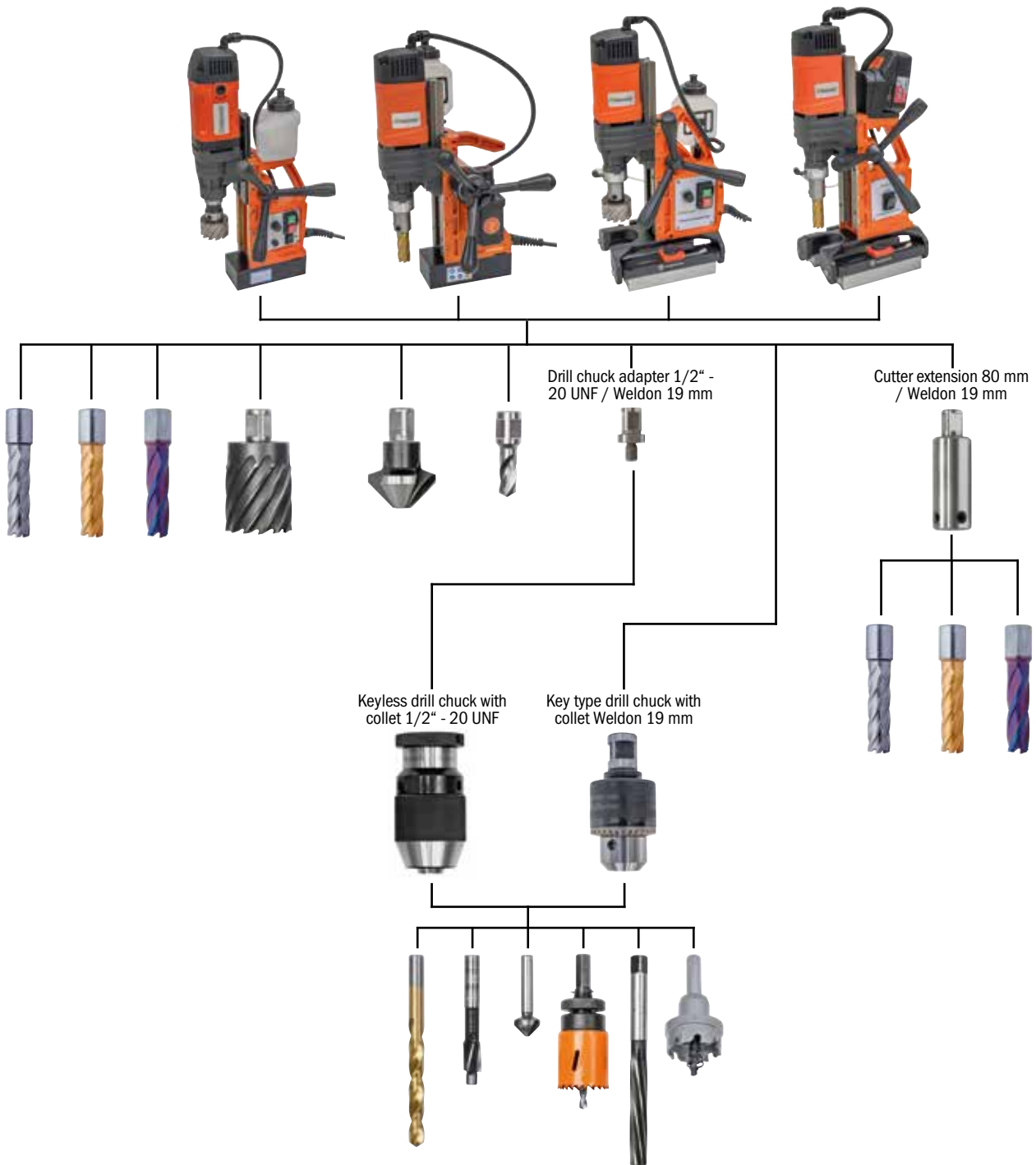

Art. no.	Description	excl. VAT	Art. no.	Description	excl. VAT
24-1075C	Key type drill chuck 1,5 - 13 mm / Weldon 19 mm		41-1105	HSS-core drills CDS, TiN-coated, 14/18/22 mm, 5 pcs.*	
24-1075D	Key type drill chuck 3 - 16 mm / Weldon 19 mm		41-11050	HSS-core drills CDL, TiN-coated, 14/18/22 mm, 5 pcs.**	
24-1076	Keyless drill chuck 1 - 13 mm / 1/2" - 20 UNF		41-11041	HSS-core drill-set CDS, TiN-coated, 14 - 24 mm*	
24-1076B	Keyless drill chuck 1 - 16 mm / 1/2" - 20 UNF		41-11042	HSS-core drill-set CDL, TiN-coated, 14 - 24 mm**	
53-1051	Drill chuck adapter 1/2" - 20 UNF / Weldon 19 mm		41-11043	HSSCO5-core drill-set CDS, nACO-coated, 14 - 24 mm***	
53-1054	Cutter extension 80 mm / Weldon 19 mm		41-11044	HSSCO5-core drill-set CDL, nACO-coated, 14 - 24 mm**	

\* Drilling depth 25 mm / \*\* Drilling depth 50 mm / \*\*\* Drilling depth 30 mm

# Magnetic core drilling and tapping machine with vario drive

## TPC 1000

- Automatic internal lubrication – coolant spreads direct on core drill
- Variable speed setting allows optimal adjustment of speed when core drilling, tapping, countersinking or reaming
- Complete with MT 2 taper for mounting of several tools (twist drills, countersinking bits, reamers, tapping chucks, keyhole saws etc.)
- Powerful, high torque drive motor features soft start and overload protection
- Powerful electro magnet guarantees high magnetic force



2-speed gearbox for ideal speed adjustment



Robust guideway for increased stability.



Automatic internal lubrication, coolant fluid goes straight to tip of core drill



Tapping chuck set optional available



Vario-drive

Right-left turning

Tapping max. M 18

**BERNARDO**  
www.bernardo.at  
**PROFESSIONAL**

Price excl. VAT

Technical data	TPC 1000
Core drill max. Ø	36 mm
Core drill max. drill depth	50 mm
Twist drill max. Ø	18 mm
Travel of drill head max.	160 mm
Tapping max.	M 18
Idle speed, stepless	100 - 360 / 360 - 660 rpm
Spindle taper	MT 2
Arbor weldon shank	19 mm
Distance spindle / base max.*	180 mm
Distance weldon shank / base max.*	80 mm
Magnetic adhesion	14200 N
Dimension magnetic base (L x W x H)	165 x 80 x 50 mm
Motor power	1550 W
Voltage	230 V
Machine dimension (W x D x H)	200 x 330 x 560 mm
Weight approx.	13,5 kg
Art. no.	01-1381

\*Extendable by up to 60 mm

### Standard accessories:

- Plastic container
- Coolant tank
- Arbor with automatic internal cooling MT 2 / Weldon 19 mm
- Safety belt
- User manual
- Tools

Drill head height can be extended, especially for long drills



# Magnetic core drilling and tapping machine with vario drive

## TPC 2000 S

- Powerful electro magnet guarantees best possible magnetic force
- Powerful, high torque drive motor features soft start and overload protection
- Complete with MT 2 taper for mounting of several tools (twist drills, countersinking bits, reamers, tapping chucks, keyhole saws etc.)
- Variable speed setting allows optimal adjustment of speed when core drilling, tapping, countersinking or reaming
- Automatic internal lubrication – coolant spreads direct on core drill

### Speed steps (LO / HI)

- |    |               |
|----|---------------|
| 1. | 100 - 320 rpm |
| 2. | 320 - 560 rpm |

Right-left turning

Tapping max. M 20

Vario-drive

Best Price

NEW



Extra strong magnetic base for perfect positioning



Precise guide rails for consistent and perfect results



2-speed gearbox for ideal speed adjustment



**BERNARDO**  
www.bernardo.at  
**PROFESSIONAL**

Price excl. VAT

Drill head height can be extended, especially for long drills

### Technical data

### TPC 2000 S

Core drill max. Ø	50 mm
Core drill max. drill depth	35 mm
Twist drill max. Ø	22 mm
Travel of drill head max.	160 mm
Tapping max.	M 20
Idle speed, stepless	100 - 320 / 320 - 560 rpm
Spindle taper	MT 2
Arbor weldon shank	19 mm
Distance spindle / base max.*	180 mm
Distance weldon shank / base max.*	80 mm
Magnetic adhesion	14500 N
Dimension magnetic base (L x W x H)	165 x 80 x 50 mm
Motor power	1700 W
Voltage	230 V
Machine dimension (W x D x H)	220 x 330 x 570 mm
Weight approx.	14 kg
Art. no.	01-13810

\*Extendable by up to 60 mm

### Standard accessories:

- Plastic container
- Coolant tank
- Bubble level
- Arbor with automatic internal cooling MT 2 / Weldon 19 mm
- Safety belt
- User manual
- Tools



**BERNARDO**  
www.bernardo.at

# Example of use MD 6050 VD / MD 8050 PF / TPC 1000 S / TPC 2000 S



Thread cutting



Core drilling with quick release tool holder



Drilling with MT 2 drill



Reaming



Countersink and deburring tools



Carbide core drill



HSS-core drill TiN-coated



HSSCO5-core drill nACO-coated



Core drilling with cutter extension



Hole saw with drill chuck



Twist drill with chuck



Countersink



# Accessories MD 6050 VD / MD 8050 PF / TPC 1000 S / TPC 2000 S

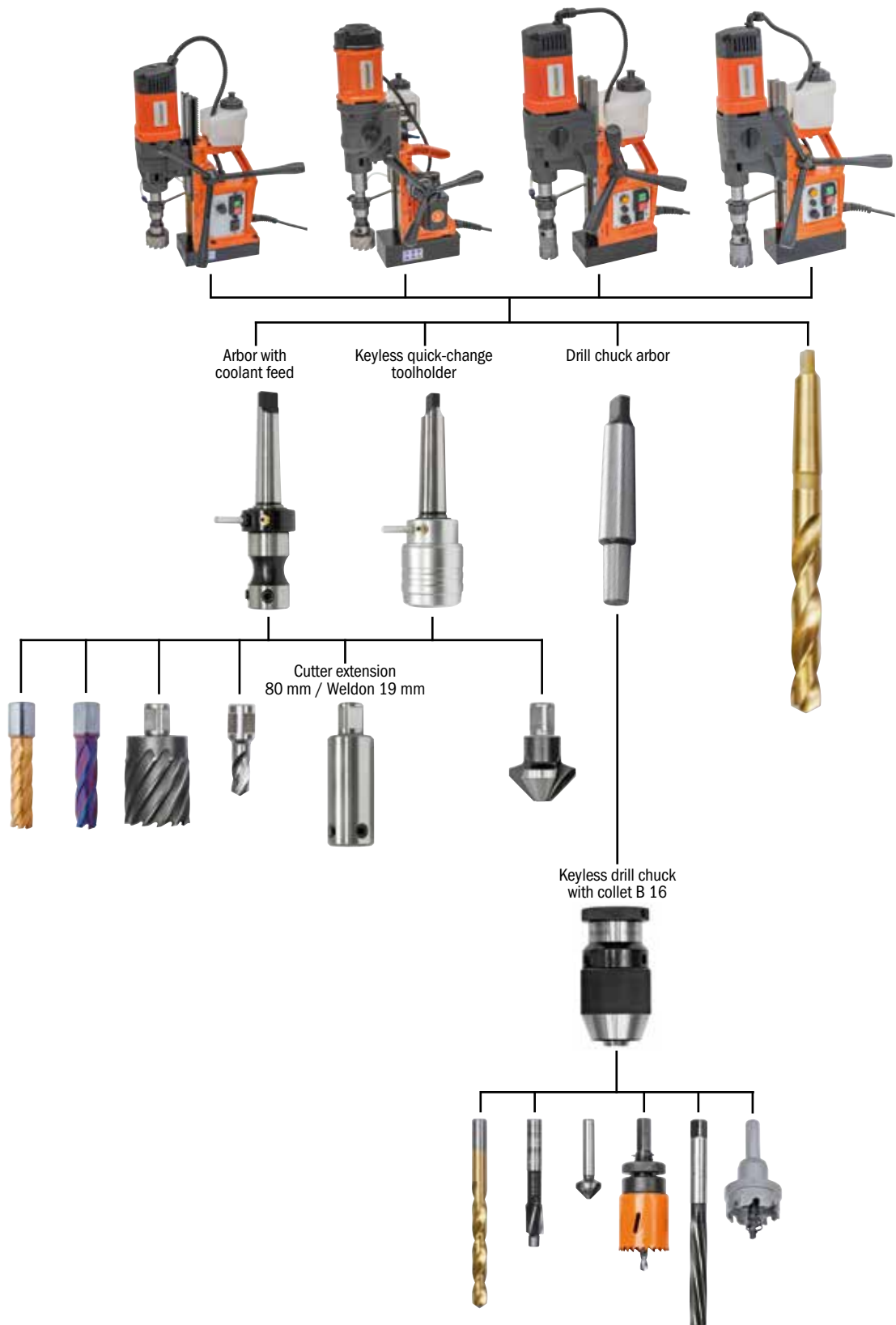

# Accessories MD 6050 VD / MD 8050 PF / TPC 1000 S / TPC 2000 S

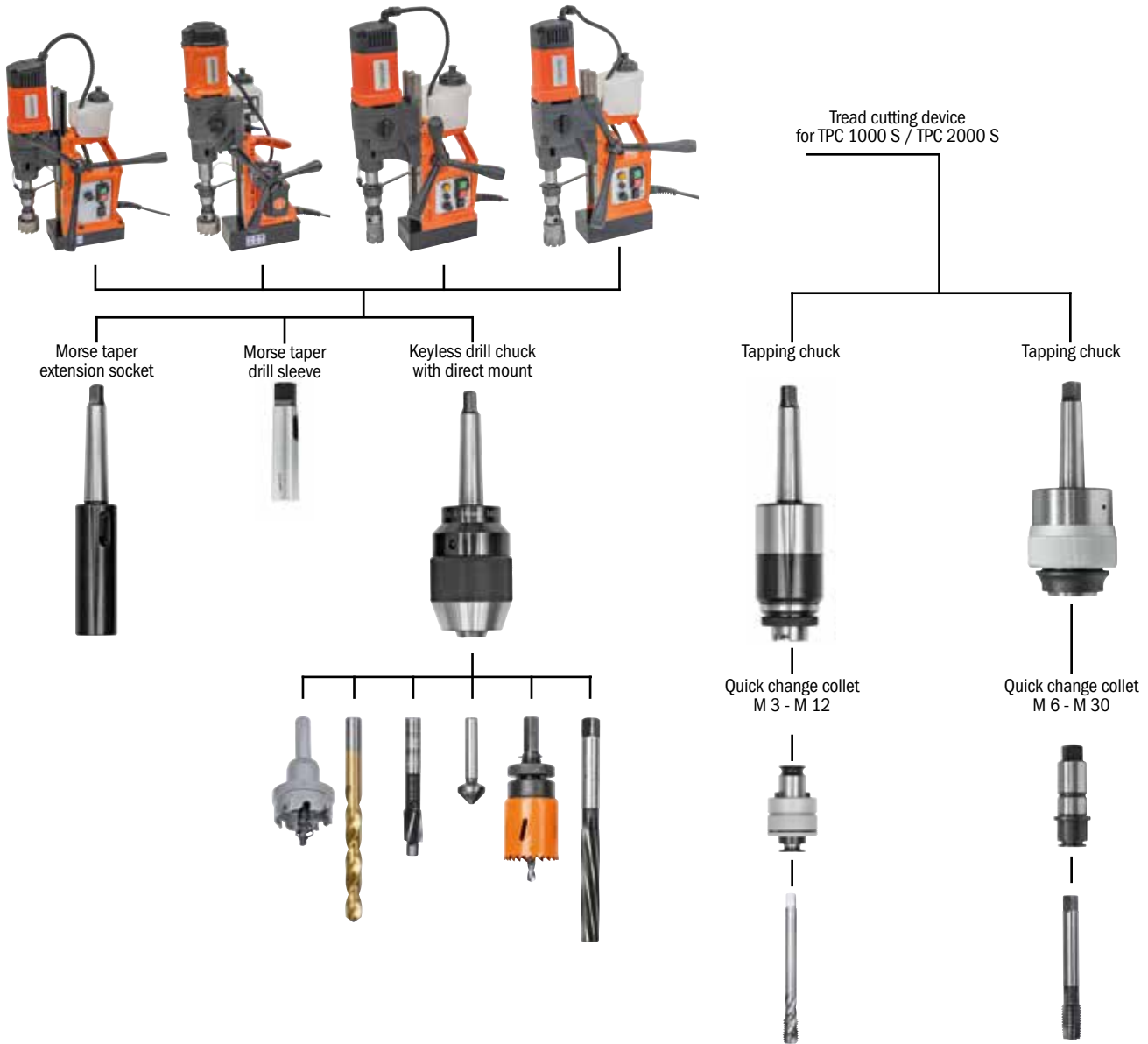

Art. no.	Description	excl. VAT	Art. no.	Description	excl. VAT
24-1002	Morse taper drill chuck arbor MT 2 - B 16		24-1098	Quick change tapping chuck set MT2 / M6-M30 / 12 pcs.	
24-1020	Morse taper drill sleeve MT 2 / 1		41-1105	HSS-core drills CDS, TiN-coated, 14/18/22 mm, 5 pcs.*	
24-1041	Morse taper extension socket MT 2 / 2		41-11050	HSS-core drills CDL, TiN-coated, 14/18/22 mm, 5 pcs.**	
24-1042	Morse taper extension socket MT 2 / 3		41-11041	HSS-core drill-set CDS, TiN-coated, 14 - 24 mm*	
24-1070	Keyless drill chuck with direct mount MT 2, 1 - 13 mm		41-11042	HSS-core drill-set CDL, TiN-coated, 14 - 24 mm**	
24-1071	Keyless drill chuck with direct mount MT 2, 1 - 16 mm		53-1054	Cutter extension 80 mm / Weldon 19 mm	
24-1081	Keyless drill chuck 1 - 13 mm / B 16		53-1089	Arbor with coolant feed MT 2 / Weldon 19 mm	
24-1082	Keyless drill chuck 1 - 16 mm / B 16		53-1096	Keyless quick-change toolholder with autom. coolant feed MT 2	
24-1089	Double roller tapping chuck set MT 2, M 3 - M 12 / 8-pcs.		54-1206	Universal coolant fluid MN 1103, 5 l canister	

\* Drilling depth 25 mm / \*\* Drilling depth 50 mm

# Magnetic core drilling and tapping machine with vario drive

## TPC 2200

- Automatic internal lubrication – coolant spreads direct on core drill
- Variable speed setting allows optimal adjustment of speed when core drilling, tapping, countersinking or reaming
- Complete with MT 3 taper for mounting of several tools (twist drills, countersinking bits, reamers, tapping chucks, keyhole saws etc.)
- Powerful, high torque drive motor features soft start and overload protection
- Powerful electro magnet guarantees high magnetic force

### Speed steps (LO / HI)

- |    |               |
|----|---------------|
| 1. | 100 - 210 rpm |
| 2. | 210 - 520 rpm |



Clearly arranged control elements.



Automatic internal lubrication, coolant fluid goes straight to tip of core drill



Delivered in high-quality transport box.



Tapping chuck set optional available



Tapping max. M 22

Right-left turning

Vario-drive

**BERNARDO**  
www.bernardo.at  
**PROFESSIONAL**

### Technical data

### TPC 2200

Core drill max. Ø	65 mm
Core drill max. drill depth	50 mm
Twist drill max. Ø	25 mm
Travel of drill head max.	200 mm
Tapping max.	M 22
Idle speed, stepless	100 - 210 / 210 - 520 rpm
Spindle taper	MT 3
Arbor weldon shank	19 mm
Distance spindle / base max.*	185 mm
Distance weldon shank / base max.*	85 mm
Magnetic adhesion	15800 N
Dimension magnetic base (L x W x H)	200 x 105 x 45 mm
Motor power	1890 W
Voltage	230 V
Machine dimension (W x D x H)	290 x 360 x 640 mm
Weight approx.	20,5 kg
Art. no.	01-13811

\*Extendable by up to 80 mm

**Best Price**

### Standard accessories:

- Plastic container
- Coolant tank
- Arbor with automatic internal cooling MT 3 / Weldon 19 mm
- Safety belt
- User manual
- Tools



**BERNARDO**  
www.bernardo.at

# Magnetic core drilling and tapping machine with vario drive

## TPC 2000 Pro

- Automatic internal lubrication – coolant spreads direct on core drill
- Complete with MT 3 taper for mounting of several tools (twist drills, countersinking bits, reamers, tapping chucks, keyhole saws etc.)
- Powerful, high torque drive motor features soft start and overload protection
- 3-step gear allows ideal speed adjustment to each workpiece
- Tool holders are designed for core drills feat. Weldon shaft 19 (standard) or 32 mm (optional)
- Powerful electro magnet guarantees high magnetic force

### Speed steps (LO / HI)

1. 100 - 210 rpm
2. 250 rpm
3. 530 rpm

**BERNARDO**  
www.bernardo.at  
**PROFESSIONAL**

Drill head height can be extended, especially for long drills

Wide range of optional accessories

Right-left turning



High-quality workmanship ensures precise results



Tapping chuck set optional available



Consistent drilling results thanks to automatic internal cooling



**Best Price**

### Technical data

### TPC 2000 Pro

Core drill max. Ø	85 mm
Core drill max. drill depth	50 mm
Twist drill max. Ø	25 mm
Travel of drill head max.	190 mm
Tapping max.	M 20
Idle speed	100 - 210 / 250 / 530 rpm
Spindle taper	MT 3
Arbor weldon shank	19 mm / 32 mm
Distance spindle / base max.*	190 mm
Distance weldon shank / base max.*	80 mm
Magnetic adhesion	16800 N
Dimension magnetic base (L x W x H)	200 x 105 x 45 mm
Motor power	1980 W
Voltage	230 V
Machine dimension (W x D x H)	300 x 390 x 680 mm
Weight approx.	18 kg
Art. no.	01-13812

\*Extendable by up to 80 mm

### Standard accessories:

- Safety belt
- Plastic container
- Bubble level
- Coolant tank
- Arbor with automatic internal cooling MT 3 / Weldon 19 mm
- User manual
- Tools

**NEW**



# Magnetic core drilling and tapping machine with vario drive

## TPC 2400 Pro

- Powerful electro magnet guarantees best possible magnetic force
- Powerful, high torque drive motor features soft start and overload protection
- Complete with MT 3 taper for mounting of several tools (twist drills, countersinking bits, reamers, tapping chucks, keyhole saws etc.)
- Variable speed setting allows optimal adjustment of speed when core drilling, tapping, countersinking or reaming
- Automatic internal lubrication – coolant spreads direct on core drill

### Speed steps (LO / HI)

- |    |               |
|----|---------------|
| 1. | 100 - 170 rpm |
| 2. | 200 rpm       |
| 3. | 430 rpm       |



Electromagnet with high holding force for firm hold



Clearly arranged operating elements and perfect adjustment of the spindle speed via potentiometer



Delivered in high-quality transport box.



Tapping chuck set optional available



Drill head height can be extended, especially for long drills

Tapping max. M 24

Right-left turning

Vario-drive

**BERNARDO**  
www.bernardo.at  
**PROFESSIONAL**

### Technical data

### TPC 2400 Pro

Core drill max. Ø	100 mm
Core drill max. drill depth	60 mm
Twist drill max. Ø	30 mm
Travel of drill head max.	200 mm
Tapping max.	M 24
Idle speed	100 - 170 / 200 / 430 rpm
Spindle taper	MT 3
Arbor weldon shank	19 mm
Distance spindle / base max.*	175 mm
Distance weldon shank / base max.*	60 mm
Magnetic adhesion	17600 N
Dimension magnetic base (L x W x H)	200 x 105 x 45 mm
Motor power	2380 W
Voltage	230 V
Machine dimension (W x D x H)	280 x 340 x 570 mm
Weight approx.	18 kg
Art. no.	01-13813

\*Extendable by up to 110 mm

### Standard accessories:

- Plastic container
- Coolant tank
- Bubble level
- Arbor with automatic internal cooling MT 3 / Weldon 19 mm
- Safety belt
- User manual
- Tools



**BERNARDO**  
www.bernardo.at

# Magnetic core drilling and tapping machine with vario drive

## TPC 3500 Vario

- Automatic internal lubrication – coolant spreads direct on core drill
- Variable speed setting allows optimal adjustment of speed when core drilling, tapping, countersinking or reaming
- Perfect positioning using standard bubble level
- Includes tool holders for core drills with 19 (standard) or 32 mm Weldon shank
- High-torque, oil-bearing drive motor with soft start and overload protection
- Powerful electro magnet guarantees best possible magnetic force
- Robuste Verarbeitungsqualität für höchste Ansprüche

### Speed steps (LO / HI)\*\*

- |    |               |
|----|---------------|
| 1. | 50 - 110 rpm  |
| 2. | 80 - 200 rpm  |
| 3. | 200 - 500 rpm |
| 4. | 320 - 800 rpm |



Clearly arranged operating elements and perfect adjustment of the spindle speed via potentiometer



Powerful drive motor designed for continuous use.



Optionally available: quick-change tapping chuck



Automatic internal lubrication, coolant fluid goes straight to tip of core drill

**BERNARDO®**  
www.bernardo.at  
**PROFESSIONAL**

**Tapping  
max. M 35**

**Right-left turning**



### Technical data

### TPC 3500 Vario

Core drill max. Ø	100 mm
Core drill max. drill depth	100 mm
Twist drill max. Ø	38 mm
Travel of drill head max.	275 mm
Tapping max.	M 35
Idle speed	50 - 800 rpm**
Spindle taper	MT 4
Arbor weldon shank	19 mm / 32 mm
Distance spindle / base max.*	290 mm
Distance weldon shank / base max.*	165 mm
Magnetic adhesion	20500 N
Dimension magnetic base (L x W x H)	245 x 125 x 50 mm
Motor power	2580 W
Voltage	230 V
Machine dimension (W x D x H)	330 x 430 x 830 mm
Weight approx.	31,5 kg
Art. no.	01-1386

\*Extendable by up to 90 mm

### Standard accessories:

- Safety belt
- Metal box
- Bubble level
- Coolant tank
- Arbor with automatic internal cooling MT 4 / Weldon 19 mm / 32 mm
- User manual
- Tools



# Magnetic core drilling and tapping machine with vario drive

- Powerful electro magnet guarantees best possible magnetic force
- Powerful, high torque drive motor features soft start and overload protection
- Standard Weldon chuck for various tools (twist drills, countersinks, reamers, thread cutting chucks, hole saws, etc.)
- Variable speed setting allows optimal adjustment of speed when core drilling, tapping, countersinking or reaming
- Automatic internal lubrication – coolant spreads direct on core drill

### Speed steps (LO / HI)\*\*

- |    |               |
|----|---------------|
| 1. | 40 - 100 rpm  |
| 2. | 70 - 180 rpm  |
| 3. | 180 - 450 rpm |
| 4. | 290 - 720 rpm |



Intuitive control panel for easy handling under difficult conditions.



Powerful drive motor with 4 gear levels for every application



Sturdy metal box with extensive accessories



Stable guides for precise machining results



Technical data	TPC 5000 Vario
Core drill max. Ø	150 mm
Core drill max. drill depth	150 mm
Twist drill max. Ø	50 mm
Travel of drill head max.	275 mm
Tapping max.	M 50
Idle speed	40 - 720 rpm**
Spindle taper	MT 4
Arbor weldon shank	19 mm / 32mm
Distance spindle / base max.*	290 mm
Distance weldon shank / base max.*	160 mm
Magnetic adhesion	24500 N
Dimension magnetic base (L x W x H)	245 x 125 x 50 mm
Motor power	3080 W
Voltage	230 V
Machine dimension (W x D x H)	370 x 430 x 840 mm
Weight approx.	31,5 kg
Art. no.	01-13861

\*Extendable by up to 90 mm



Operating lever can be mounted on both sides

Right-left turning

Best Price

### Standard accessories:

- Safety belt
- Metal box
- Coolant tank
- Arbor with automatic internal cooling MT 4 / Weldon 19 mm / 32 mm
- User manual
- Tools

Tapping max. M 50

# Pipe adapter TH 250/TH 550

- Easy handling and precise fastening
- Ideal for pipe processing and demanding workstations
- Robust construction for precise results
- For safe operation and maximum stability during the drilling process
- Robust workmanship for the highest demands



TH 250 / 75 mm - 250 mm / Art. no. 01-1388



TH 550 / 250 mm - 550 mm / Art. no. 01-13880

## Application examples TH 250/TH 550



TH 250



TH 550

**Maximum grip in demanding working conditions**

Our pipe clamping fixtures for magnetic drilling machines provide reliable and secure fixation on pipes and round workpieces during the drilling process. These fixtures ensure stable positioning of the magnetic drilling machine, particularly in applications where drilling is carried out on non-magnetic or round surfaces.





# Accessories TPC 2200 / TPC 2000 Pro / TPC 2400 Pro

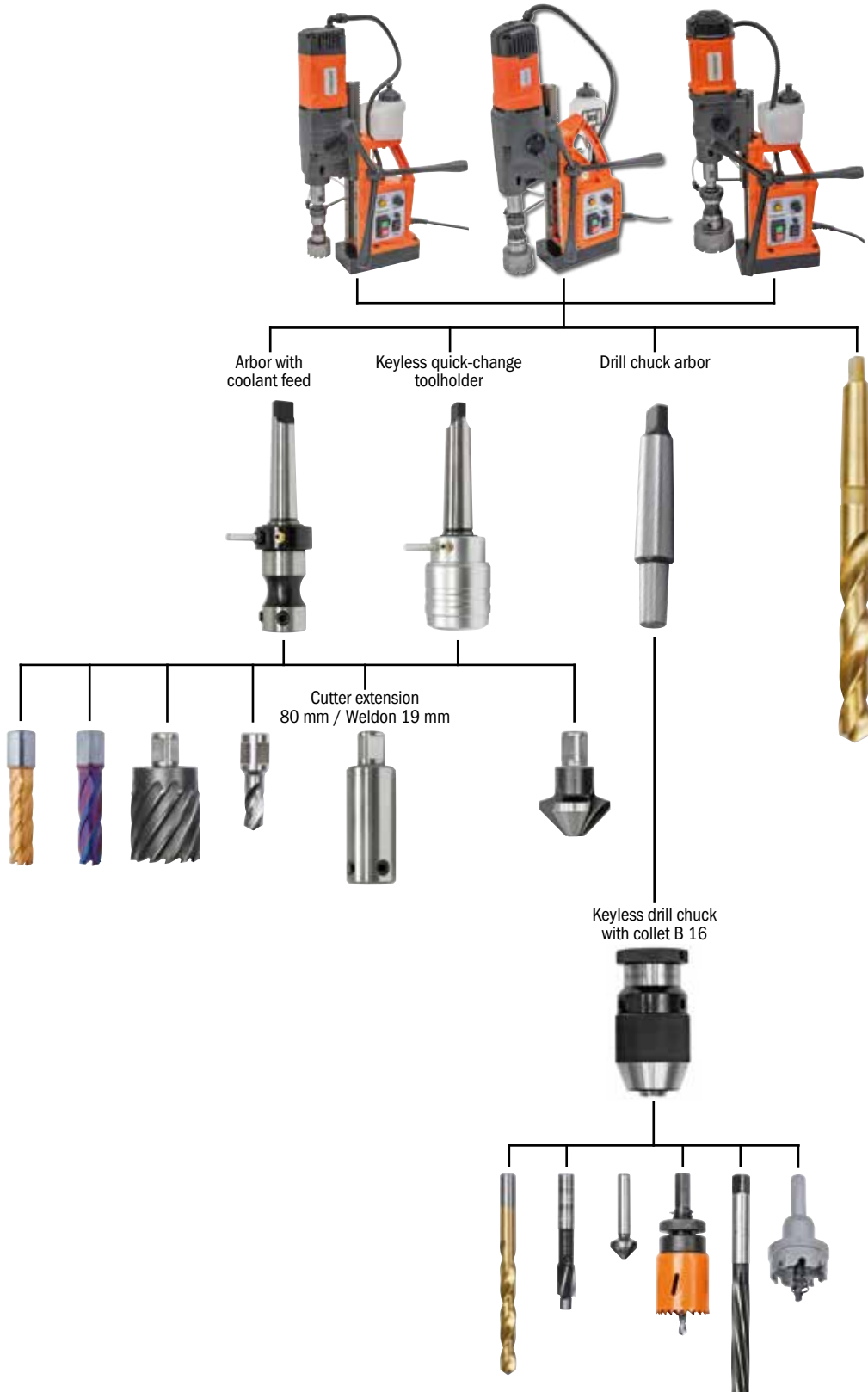

# Accessories TPC 2200 / TPC 2000 Pro / TPC 2400 Pro

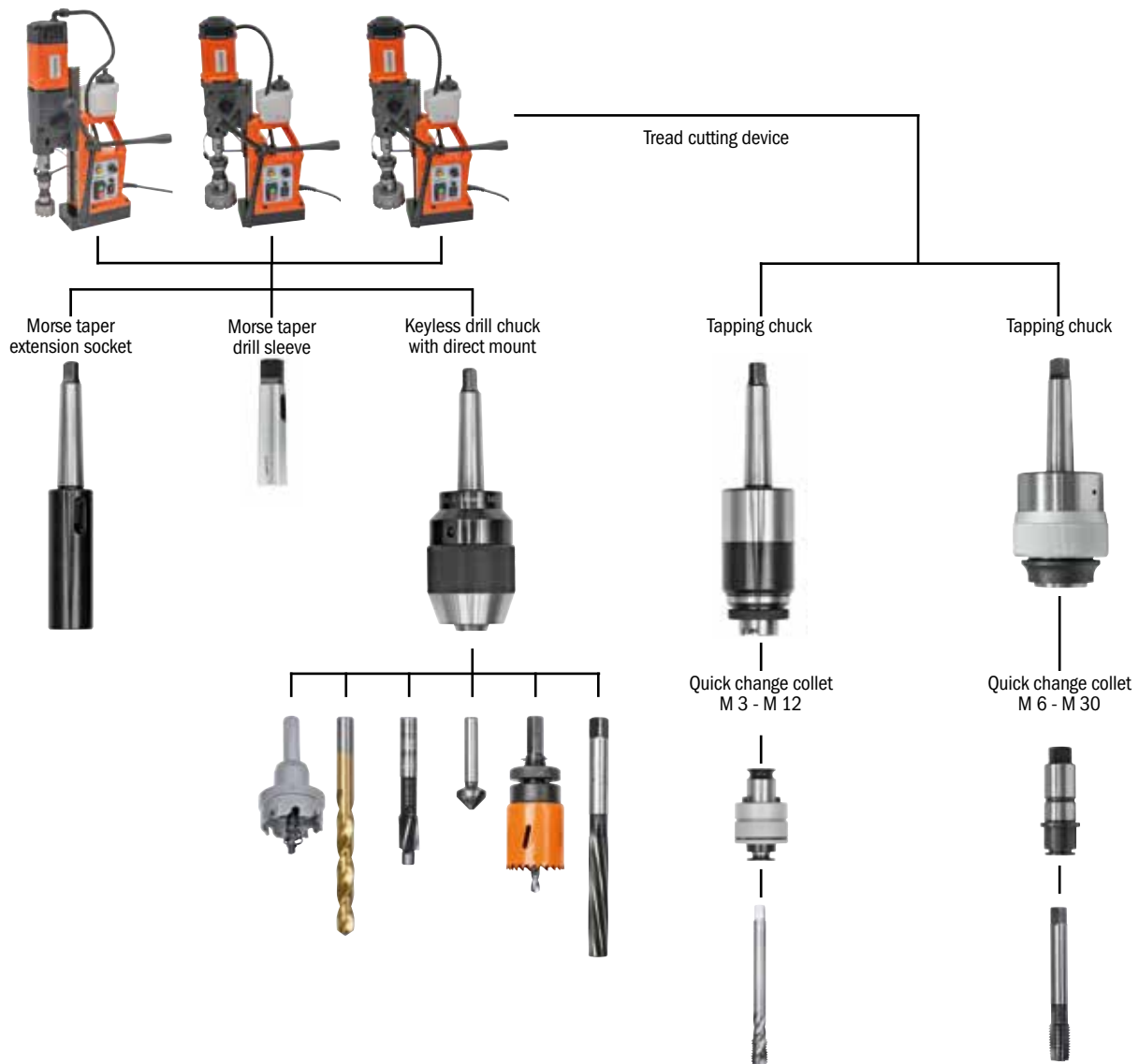

Art. no.	Description	excl. VAT	Art. no.	Description	excl. VAT
24-1005	Morse taper drill chuck arbor MT 3 - B 16		24-1099	Quick change tapping chuck set MT3 / M6-M30 / 12 pcs.	
24-1022	Morse taper drill sleeve MT 3 / 2		41-11050	HSS-core drills CDL, TiN-coated, 14/18/22 mm, 5 pcs.*	
24-1043	Morse taper extension socket MT 3 / 2		41-11042	HSS-core drill-set CDL, TiN-coated, 14 - 24 mm*	
24-1044	Morse taper extension socket MT 3 / 3		53-1054	Cutter extension 80 mm / Weldon 19 mm	
24-1072	Keyless drill chuck with direct mount MT 3, 1 - 16 mm		53-1090	Arbor with coolant feed MT 3 / Weldon 19 mm	
24-1081	Keyless drill chuck 1 - 13 mm / B 16		53-1091	Arbor with coolant feed MT 3 / Weldon 32 mm	
24-1082	Keyless drill chuck 1 - 16 mm / B 16		53-1097	Keyless quick-change toolholder with autom. coolant feed MT 3	
24-1090	Double roller tapping chuck set MT 3, M 3 - M 12 / 8-pcs.		54-1206	Universal coolant fluid MN 1103, 5 l canister	
24-1092	Double roller tapping chuck set MT 3, M 12 - M 24 / 8-pcs.		54-1208	High-performance cutting oil BDS 5000 / 1 ltr.	

\* Drilling depth 50 mm

# Accessories core drilling machines

## Arbor with coolant feed



- With automatic internal cooling for core drills
- For drilling machines with MT-taper
- For mounting of tools with weldon shaft 19 und 32 mm

Art.no.	Description	excl. VAT
53-1089	Arbor with coolant feed MT 2 / Weldon 19 mm	
53-1090	Arbor with coolant feed MT 3 / Weldon 19 mm	
53-1091	Arbor with coolant feed MT 3 / Weldon 32 mm	
53-1092	Arbor with coolant feed MT 4 / Weldon 32 mm	
53-1093	Arbor with coolant feed MT 5 / Weldon 32 mm	



## Keyless quick-change tool holder with automatic coolant feed



- With automatic internal cooling for core drills with weldon shaft 19 mm
- Quick tool changing without wrench
- Including tube and quick-lock coupling

Art.no.	Description	excl. VAT
53-1096	Keyless quick-change toolholder with automatic coolant feed MT 2	
53-1097	Keyless quick-change toolholder with automatic coolant feed MT 3	



## Drill chuck adapter



- Adapter from Weldon 19 mm to 1/2" - 20 UNF
- For mounting of key type and keyless drill chucks

Art.no.	Description	excl. VAT
53-1051	Drill chuck adapter 1/2" - 20 UNF / Weldon 19 mm	€



## Cutter extension



- Weldon shaft extension 80 mm
- For mounting of tools with weldon shaft 19 mm
- Application at deep or stepeed workpiece surfaces
- Including ejector pin

Art.no.	Description	excl. VAT
53-1054	Cutter extension 80 mm / Weldon 19 mm	



# Accessories core drilling machines

## Quick change drilling and tapping chuck set M 3 - M 12 / M 12 - M 24

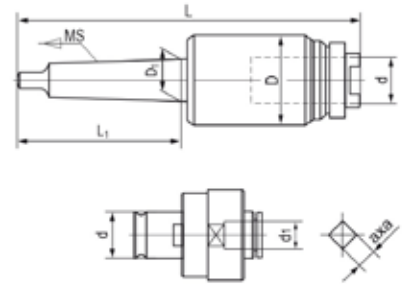

Content M 3 - M 12:  
M 3 / M 3,5 / M 4 / M 5 - 6 / M 8 / M 10 / M 12

Content M 12 - M 24:  
M 12 / M 14 / M 16 / M 18 / M 20 / M 22 / M 24

- For use of screw tap for through hole or blind holes
- Quick change inserts serially with adjustable safety overload clutch
- Machined thread cutting with hand feed at core drilling machines, table and column drilling machines,....
- Quick and easy change of the screw without tools
- Useable on machines with left and right turning
- Maintenance free execution

Art.no.	Morse taper	D	D1	d	L1	L	Cutting range	Torque	Weight approx. excl. VAT
24-1089	MT 2	46 mm	17,780 mm	19 mm	75 mm	171,5 mm	M 3 - M 12	25 Nm	1,08 kg
24-1090	MT 3	46 mm	23,825 mm	19 mm	94 mm	191 mm	M 3 - M 12	25 Nm	1,28 kg
24-1092	MT 3	66 mm	23,825 mm	30 mm	94 mm	227 mm	M 12 - M 24	150 Nm	3,20 kg

## Quick change drilling and tapping chuck set M 6 - M 30

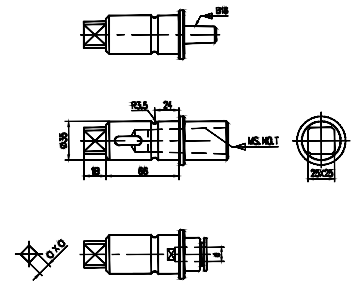
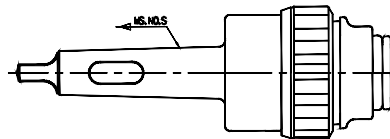

- Quick and easy change of the screw tape without tools
- For use of screw tap for through hole or blind holes
- Useable on machines with left and right turning
- Tapping chuck serially with safety overload clutch
- Machined thread cutting with hand feed at core drilling machines, table and column drilling machines,....
- Maintenance free execution

Cutting range	M 6 - M 8	M 10	M 12	M 16	M 18 - M 20	M 24	M 27 - M 30
d x a	6,3 x 5 mm	8 x 6,3 mm	9 x 7,1 mm	12,5 x 10 mm	14 x 11,2 mm	18 x 14 mm	20 x 16 mm

Art. no.	Morse taper	Drilling range	Cutting range	Reducer	Thread cutting inserts	excl. VAT
24-1098	MT 2	3 - 31,5 mm	M 6 - M 30	MT 1 / MT 2 / MT 3	M 6 - 8 / 10 / 12 / 16 / 18 - 20 / 24 / 27 - 30	
24-1099	MT 3	3 - 31,5 mm	M 6 - M 30	MT 1 / MT 2 / MT 3	M 6 - 8 / 10 / 12 / 16 / 18 - 20 / 24 / 27 - 30	



# Accessories core drilling machines

## Morse taper drill chuck arbor



- Completely hardened and grounded
- For taper according to DIN 238
- For mounting of drill chucks on machines with morse taper

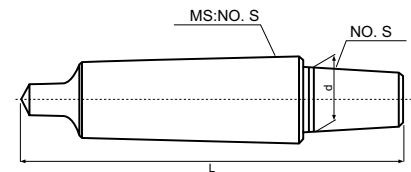

Art.no.	Description	Morse taper	Short taper	Length	d	excl. VAT
24-1002	Drill chuck arbor MT 2 - B 16	MT 2	B 16	112 mm	15,773 mm	
24-1005	Drill chuck arbor MT 3 - B 16	MT 3	B 16	131 mm	15,773 mm	

## Morse taper drill sleeve



- Precision execution, completely hardened
- Internal and external taper grounded according DIN 2185

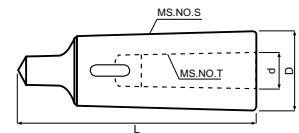

Art.no.	Description	Morse taper	Length	D	d	excl. VAT
24-1022	Morse taper drill sleeve MT 3/2	MT 3	MT 2	112 mm	24,7 mm	17,780 mm

## Morse taper extension socket



- Precision execution, completely hardened
- Internal and external taper grounded according DIN 2187

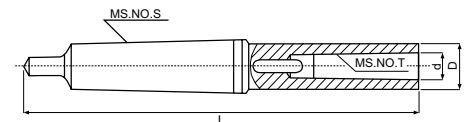

Art.no.	Description	Morse taper	Length	D	d	excl. VAT
24-1041	Morse taper extension socket MT 2 / 2	MT 2	MT 2	175 mm	30 mm	17,780 mm
24-1042	Morse taper extension socket MT 2 / 3	MT 2	MT 3	196 mm	36 mm	23,825 mm
24-1043	Morse taper extension socket MT 3 / 2	MT 3	MT 2	194 mm	30 mm	17,780 mm
24-1044	Morse taper extension socket MT 3 / 3	MT 3	MT 3	215 mm	36 mm	23,825 mm

## Key type drill chuck with mounting thread



- Execution for machines with right turning
- Application at stationary and hand-operated drilling machines
- With Weldon shaft 19 mm
- Steady clamping force at drilling

Art.no.	Description	excl. VAT
24-1075C	Key type drill chuck 1,5 - 13 mm / Weldon 19 mm	
24-1075D	Key type drill chuck 3 - 16 mm / Weldon 19 mm	



# Accessories core drilling machines

## Keyless drill chuck with mounting thread



- With internal thread 1/2" - 20 UNF
- For keyless clamping of the tools
- High concentricity and maximum clamping force
- All wear parts case-hardened and grounded



Art.no.	Description	excl. VAT
24-1076	Keyless drill chuck 1-13 mm / 1/2" - 20 UNF	
24-1076B	Keyless drill chuck 1-16 mm / 1/2" - 20 UNF	

## Keyless drill chuck with internal taper

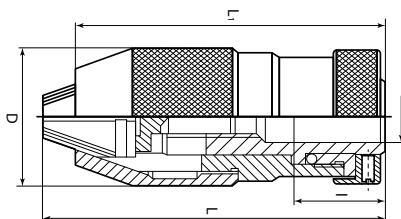

- With internal taper B 16
- For keyless clamping of the tools
- High concentricity and maximum clamping force
- All wear parts case-hardened and grounded

Art.no.	Clamping range	Short taper	d	l	D	L	L1	Weight approx. excl. VAT
24-1082	1 - 16 mm	B 16	15,773 mm	24,000 mm	54 mm	112,2 mm	102 mm	1,268 kg

## Keyless drill chuck with direct mount



- Execution with integrated arbor MT 2 or MT 3
- Easy clamping and loosening by hand even after heavy use
- All wear parts case-hardened and grounded
- For keyless clamping of the tools

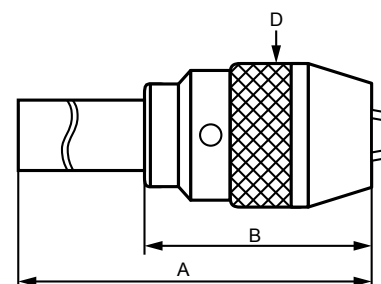

Art. no.	Clamping range	Morse taper	A	B	D	Weight approx. excl. VAT
24-1070	1 - 13 mm	MT 2	160 mm	80 mm	50,5 mm	1,00 kg
24-1071	1 - 16 mm	MT 2	165 mm	85 mm	57 mm	1,32 kg
24-1072	1 - 16 mm	MT 3	184 mm	85 mm	57 mm	1,48 kg

# Accessories core drilling machines

## TCT-core drill-set



The carbide core drills with high-quality hard metal coating and optimized cutting edge geometry guarantee a long service life and excellent cutting performance at difficult-to-machine materials such as chrome-nickel steel, but also non-ferrous materials, aluminum, structural steel, .... The sets include the most commonly used sizes with a drilling depth of 35 mm.

- With Weldon shaft 19 mm
- Delivery in stable plastic box
- Tungsten carbide tipped
- High wear protection
- Very good chip removal
- Drill depth 30 mm

Content:  
each 1 pc. 14 / 16 / 18 / 20 / 22 mm  
2 pcs. ejector pin

Art.no.	Description	excl. VAT
41-1106	TCT-core drill-set, 14 - 22 mm, drilling depth 35 mm	

## HSS-core drill-set, TiN-coated / nACO-coated

The TiN- and nACO-coated core drill-sets are out of high speed steel and designed for professional use. The sets contain the most frequently used sizes and are available with a drill depth of 25 mm and 50 mm (TiN-coated) or 30 mm and 50 mm (nACO-coated). Core drills are often better suited than twist drills because of the small ring which is being drilled as opposed to the entire drill area, resulting in less need for force.



Content:  
• 2 pcs. 14 mm  
• 2 pcs. 18 mm  
• 1 pc. 22 mm

### HSS-core drill TiN-coated

- With Weldon shaft 19 mm
- Very good chip removal
- High speed steel
- High wear protection
- Drill depth 25 mm (CDS) or 50 mm (CDL)

Art.no.	Description	excl. VAT
41-1105	HSS-core drills CDS, 14/18/22 mm, drilling depth 25 mm, 5 pcs.	
41-11050	HSS-core drills CDL, 14/18/22 mm, drilling depth 50 mm, 5 pcs.	
41-11053	Ejector pin 6,34 x 77 mm (for 41-1105)	
41-11054	Ejector pin 6,34 x 103 mm (for 41-11050)	

### HSSCO5-core drill nACO-coated

- With Weldon shaft 19 mm
- Very good chip removal
- High speed steel
- Hard coating
- High wear protection
- High hardness and adhesive strength
- Drill depth 30 mm (CDS) or 50 mm (CDL)



Content:  
• 2 pcs. 14 mm  
• 2 pcs. 18 mm  
• 1 pc. 22 mm

Art.no.	Description	excl. VAT
41-11051	HSSCO5-core drills CDS, 14/18/22 mm, drilling depth 30 mm, 5 pcs.	
41-11052	HSSCO5-core drills CDL, 14/18/22 mm, drilling depth 50 mm, 5 pcs.	
41-11053	Ejector pin 6,34 x 77 mm (for 41-11051)	
41-11054	Ejector pin 6,34 x 103 mm (for 41-11052)	

# Accessories core drilling machines

## HSS-standard core drill-set

The HSS-standard core drill-set is out of high speed steel and designed for professional use. The sets contain the most frequently used sizes and are available with a drill depth of 25 mm or 50 mm.



### HSS-standard core drill-set

- With Weldon shaft 19 mm
- Delivery in stable plastic box
- High speed steel
- Very good chip removal
- Drill depth 25 mm (CDS) or 50 mm (CDL)

Content:  
each 1 pc. 14 / 16 / 18 / 20 / 22 / 24 mm  
1 pc. ejector pin

Art.no.	Description	excl. VAT
41-1104	HSS-standard core drill-set CDS, 14 - 24 mm, drilling depth 25 mm	
41-11040	HSS-standard core drill-set CDL, 14 - 24 mm, drilling depth 50 mm	

## HSS-core drill-set, TiN-coated / nACO-coated

The TiN- and nACO-coated core drill-sets are out of high speed steel and designed for professional use. The sets contain the most frequently used sizes and are available with a drill depth of 25 mm and 50 mm (TiN-coated) or 30 mm and 50 mm (nACO-coated). Core drills are often better suited than twist drills because of the small ring which is being drilled as opposed to the entire drill area, resulting in less need for force.



### HSS-core drill TiN-coated

- With Weldon shaft 19 mm
- Delivery in stable plastic box
- Very good chip removal
- High speed steel
- High wear protection
- Drill depth 25 mm (CDS) or 50 mm (CDL)

Content:  
each 1 pc. 14 / 16 / 18 / 20 / 22 / 24 mm  
1 pc. ejector pin

Art.no.	Description	excl. VAT
41-11041	HSS-core drill-set CDS, 14 - 24 mm, drilling depth 25 mm	
41-11042	HSS-core drill-set CDL, 14 - 24 mm, drilling depth 50 mm	



### HSSC05-core drill nACO-coated

- With Weldon shaft 19 mm
- Delivery in stable plastic box
- Very good chip removal
- High speed steel
- Hard coating
- High wear protection
- High hardness and adhesive strength
- Drill depth 30 mm (CDS) or 50 mm (CDL)

Content:  
each 1 pc. 14 / 16 / 18 / 20 / 22 / 24 mm  
1 pc. ejector pin

Art.no.	Description	excl. VAT
41-11043	HSSC05-core drill-set CDS, 14 - 24 mm, drilling depth 30 mm	
41-11044	HSSC05-core drill-set CDL, 14 - 24 mm, drilling depth 50 mm	



# Accessories core drilling machines

## Countersink and deburring tools

Using countersink and deburring tools, bores can be deburred or recesses made for countersunk screws or rivets. The countersink and deburring tools from BERNARDO are available with cylindrical shaft or Weldon 19 mm. The precise execution guarantee vibration-free work and perfect results.



- 6-pcs. set out of HSS in metal box
- With cylindrical shaft
- Countersink angle 90°, 3 cutting edges
- according to DIN 335-C

Content:  
each 1 pc. 6,3 / 8,3 / 10, 4 / 12,4 / 16,5 / 20,5 mm

Art.no.	Description	excl. VAT
41-1075	6 pcs. HSS countersink set 90°	

- 4-pcs. set out of HSS-TiN in metal box
- With cylindrical shaft
- Optimal chip removal through bore in shaft direction

Content:  
each 1 pc. 2 - 5 mm / 5 - 10 mm / 10 - 15 mm / 15 - 20 mm

Art.no.	Description	excl. VAT
41-1080	4 pcs. countersink and deburring tool	



- Countersink angle 90°, 3 cutting edges
- With Weldon shaft 19 mm
- Countersink range from 15 - 50 mm

Art.no.	Description	excl. VAT
41-1076	Countersink and deburring tool 90°, 15 - 50 mm, Weldon 19	

## Core drill set



Core drill set are suitable for core drilling machines when drilling small holes with a diameter from 6 - 13 mm. Significant advantages compared to twist drills are the Weldon direct chuck which allows for better stability as well as the two cutting edges which eliminate the need for a centre punch

Recommended cutting speed:  
Vc = approx. 30 m/min.

Core drill: 6 / 8 / 10 / 11 / 12 / 13 mm  
Drill depth: 30 mm  
Shaft: Weldon 19 mm

Art.no.	Description	excl. VAT
41-1103	Core drill set, 6 - 13 mm, drill depth 30 mm, 6-pcs.	

## Miscellaneous accessories



This device attracts chips by a strong magnetic force which can then be manually released by pulling the button. Convenient removal and collection of magnetic chips. Makes keeping your work place tidy with easy.

Art.no.	Description	excl. VAT
51-1050	Magnetic chip collector	

# Accessories core drilling machines

## Universal coolant fluid MN 1103



Coolant fluid - to be diluted with water - features outstanding performance and is highly efficient. Content makes up to 200 l coolant emulsion.

The special additions increase the durability and improve the chip flow, this guarantee a better cutting result on the machined material.

This concentrat is designed for all machining processes of steel and non-ferrous metal, for example drilling, milling, sawing, turning etc.

Application concentration (Oil:Water)  
Drilling, milling, turning 1:20 to 1:40

Art.no.	Description	excl. VAT
54-1206	Universal coolant fluid MN 1103, 5 l canister	

## High-performance cutting oil BDS 5000



High-performance cutting oil for medium to heavy machining of metals and plastics.

The excellent coolant and lubrication effect increase the durability of the tools and improve the chip removal, this guarantee a veter cutting result on the machined material.

Art.no.	Description	excl. VAT
54-1208	High-performance cutting oil BDS 5000 / 1 ltr.	
54-1209	High-performance cutting oil BDS 5000 / 5 ltr.	

## High-performance lubrication spray BDS 5200



Application mainly at over head or horizontal work, but also useable for machining at drilling , milling, sawing, thread cutting etc.

Advantage of this lubrication spray is the exact dosing and therefore an optimal lubrication directly at the cutting tool.

Art.no.	Description	excl. VAT
54-1210	High-performance lubrication spray BDS 5200 / 1 x 400 ml can	
54-1211	High-performance lubrication spray BDS 5200 / 6 x 400 ml can	
54-1212	High-performance lubrication spray BDS 5200 / 12 x 400 ml can	

## High-performance cutting paste BDS 5500



Optimal useable for metals, high-alloyed steels, nickel-chromium alloy, rust and heat -resistant steels.

Applycation mainly at over head or horizontal work (for example core drilling), but also useable for sawing, reaming, broaching etc.

Art.no.	Description	excl. VAT
54-1207	High-performance cutting paste BDS 5500 / 1000 g	

notes

A large grid of graph paper for taking notes, consisting of 20 columns and 30 rows of small squares.

**Imprint:**

All rights reserved – reproduction of images or texts or parts of these is strictly prohibited unless prior arrangements are made. Subject to technical and optical amendments. Product specifications subject to change without notice. Not responsible for printing errors or mistakes. Machines are partly displayed with optional extras. Prices subject to change. Prices in Euros, ex works (Linz, Austria), excl. any taxes. Edition 05/2025.

Your dealer

**BERNARDO**<sup>®</sup>  
www.bernardo.at

PWA Handelsges.m.b.H.  
4020 Linz | Nebingerstraße 7a | Austria  
phone: +43.732.66 40 15 | fax: +43.732.66 40 15-9  
e-mail: [bernardo@pwa.at](mailto:bernardo@pwa.at) | [www.bernardo.at](http://www.bernardo.at)